



Two-piece joist hangers can be adapted to wood sections with widths between 60 and 120 mm. It is essential to install nails in the base of the joist hanger to ensure a solid assembly.



[UK-DoP-e06/0270](#), [ETA-06/0270](#)

FEATURES



Material

- Galvanised steel S250GD + Z275 according to NF EN 10346.

Avantages

- Great flexibility in use in new and refurbished condition.

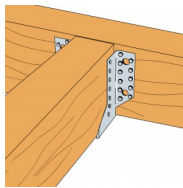

APPLICATIONS

Support

- Supporting member:** wood, concrete, steel.
- Supported member:** solid wood, composite lumber.

Intend Use

- Joists.
- Refurbishment of existing assemblies.

TECHNICAL DATA

Product Dimensions

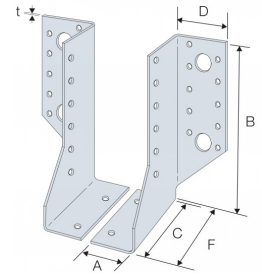
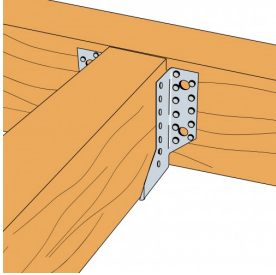

References	Joist Size [mm]				Product Dimensions [mm]						Header holes		Joist holes
	Width		Height		A	B	C	D	F	t	Ø5	Ø13	Ø5
	Min	Max.	Min	Max.									
SDE300/30	60	160	120	177	60	118	84	41.5	86	2	18	4	14
SDE340/30	60	160	140	207	60	138	84	41.5	86	2	22	4	16
SDE380/30	60	160	160	237	60	158	84	41.5	86	2	22	4	16
SDE440/30	60	160	190	282	60	188	84	41.5	86	2	28	4	20

Product capacities - Timber to timber - Full nailing Br36

References	Characteristic capacities - Timber to timber - Full nailing											
	Number of Fasteners				Product characteristic capacities - Timber C24 [kN]				Safe Working Loads [kN]			
	Header		Joist		R _{1,k}		R _{2,k}		R _{1,SWL,Long Term}		R _{2,SWL,Short Term}	
	Qty	Type	Qty	Type	N3,75x30	Ø4,0x100	N3,75x30	Ø4,0x100	N3,75x30	Ø4,0x100	N3,75x30	Ø4,0x100
SDE300/30	18	N3,75 or CNA*	10	N 3,75x30	3	9.6	4.5	9.6	1.3	4	2.3	4.8
SDE340/30	22	N3,75 or CNA*	12	N 3,75x30	3.9	11.5	6.3	11.5	1.6	4.8	3.2	5.8
SDE380/30	22	N3,75 or CNA*	12	N 3,75x30	11.5	11.5	6.3	11.5	4.8	4.8	3.2	5.8
SDE440/30	28	N3,75 or CNA*	14	N 3,75x30	14.3	14.3	9.4	14.3	6	6	4.7	7.2

*Refer to Characteristic Capacity table columns for type of fasteners that can be used in the header. Capacities vary depending on fastener type used

INSTALLATION

Fasteners

On wood:

- CNA annular ring-shank nails dia. 4.0 x 50 mm.
- Lag screws and bolts dia. 10 or dia. 12 mm.

On concrete:

Concrete substrate:

- Mechanical anchor: WA M12-104/5 pin.
- Chemical anchor: AT-HP resin + LMAS M12-150/35 threaded rod.

Hollow masonry substrate: (check the load bearing capacity of the anchors)

- Chemical anchor: AT-HP or POLY-GP resin + LMAS M12-150/35 + SH M16-130 screen.

Installation

- Use all specified fasteners.
- Check that the header can accommodate the specified fasteners.
- Each SDE must be nailed through the holes underneath the joist.

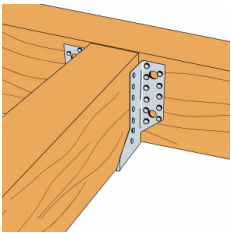

Installation
Timber to timber